

CITYREALTY

NEW DEVELOPMENT OF THE DAY

Claremont Hall

Sales underway at Morningside Heights' tallest building

Gracious condos with sweeping views from \$1.05M | Beautifully curated amenities



Rising 41 stories from the distinguished campus of Union Theological Seminary, **Claremont Hall** is a new landmark that seamlessly connects the academic and cultural tradition of Manhattan's West Side with enlightened contemporary living. With soaring Gothic style, several setbacks, and a dramatic crown envisioned by New York's most celebrated architect, **Robert A.M. Stern**, Claremont Hall combines expansive park, city and river views, with bright modern residences at a historic location over a century in the making.

LEARN MORE

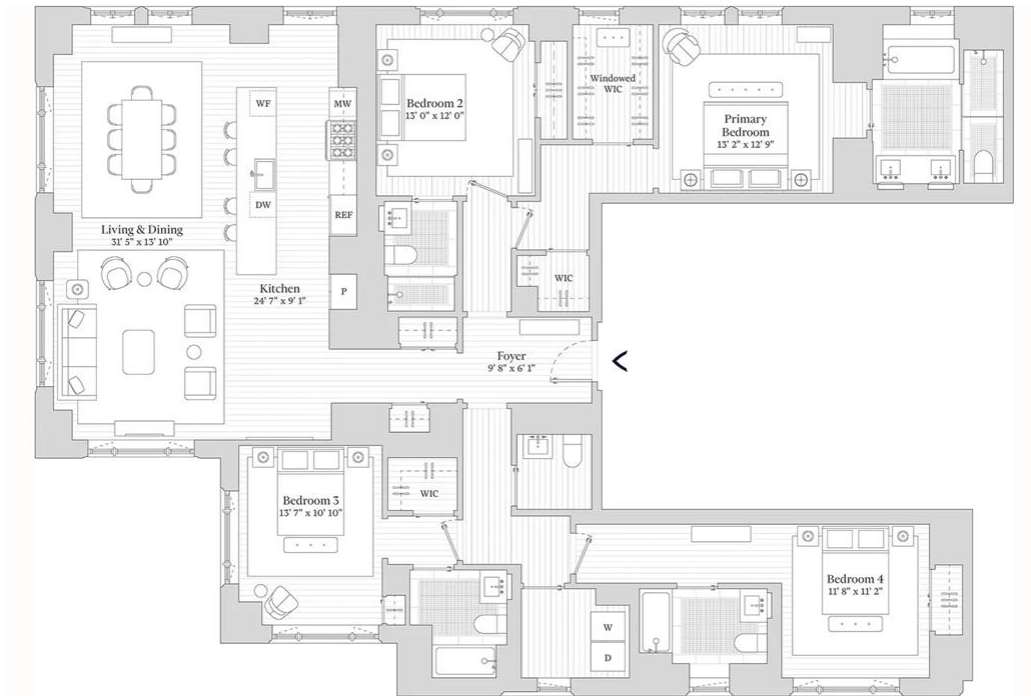

Claremont Hall, #39A

Condo in [Morningside Heights](#)

\$6,750,000

4 beds, 4.5 baths | 2,764 ft²

Residence #39A, a sprawling four-bedroom condo with postcard-perfect views, is centered on a thirty-foot living/dining room and open kitchen with extra-long island, custom Italian cabinetry, and paneled appliance package from Bosch. The primary suite faces west and comes with dual walk-in closets and windowed five-fixture bath with soaking tub. Three additional bedrooms, all with en suite baths, complete this Claremont Hall home.

VIEW LISTING



Claremont Hall, #32C

Condo in [Morningside Heights](#)

\$3,825,000

3 beds, 2.5 baths | 1,663 ft²

Residence #32C, a three-bedroom home with two full baths and powder room, offers sweeping northern and western views over the Hudson River, Riverside and Sakura Parks, and the iconic spire of Riverside Church from oversized, high-performance windows and the private loggia off the living room. Interiors feature ceilings up to 10 feet high, wide plank European white oak flooring, and a refined finish palette hand-selected by Robert A.M. Stern Architects. The west-facing primary suite boasts a walk-in closet and five-fixture bath with deep soaking tub and glass-enclosed walk-in shower.

[VIEW LISTING](#)



Claremont Hall, #10F

Condo in [Morningside Heights](#)

\$2,495,000

3 beds, 3 baths | 1,577 ft²

Residence #10F is situated on Claremont Hall's tranquil northwestern corner and incorporates an 8' bay picture window in the open-concept living room. The oversized living/dining area offers seamless access to a kitchen with custom Italian cabinetry, Calacatta Lanza marble countertops, and paneled Bosch appliances, including wine fridge and custom range hood with spice shelf. All three bedrooms have generous closet space, and the primary suite boasts a walk-in.

[VIEW LISTING](#)



Claremont Hall, #12B

Condo in [Morningside Heights](#)

\$2,225,000

2 beds, 2 baths | 1,375 ft²

Residence #12B faces southeast over the historic, tranquil courtyard of the Union Theological Seminary. Inside, the spacious, sunny L-shaped living and dining room is ideal for everyday living and adjoins a U-shaped kitchen that is perfect for home chefs. The primary suite is located in a private wing and features a triple-paneled window, a spacious walk-in closet, and an ensuite windowed bath with double vanity and glass enclosed walk-in shower. The secondary bedroom is adjacent to a bath with a deep soaking tub.

[VIEW LISTING](#)



Claremont Hall, #12G

Condo in [Morningside Heights](#)

\$1,550,000

1 bed, 2 baths | 1,036 ft²

Spanning 1,036 square feet, **Residence #12G** features one sizeable bedroom, two full baths and a sizable, flexible study space that can accommodate a variety of uses. The corner living room enjoys a sunny southern exposure with views to the Midtown skyline, and western views overlooking the grandeur of Riverside Church, Riverside Park, and the Hudson River. An expansive L-shaped kitchen with breakfast bar, custom Italian cabinetry, and paneled appliance package from Bosch, including a wine refrigerator, opens to the graceful living and dining space.

[VIEW LISTING](#)



Claremont Hall's carefully curated amenity collection was designed in partnership with CetraRuddy Architects, and provides space and resources for the replenishment of mind, body, and spirit. A fitness center overlooks the seminary's courtyard and features a separate movement studio. A library with leatherbound classics is ideal for remote work, and a soundproof Rehearsal Hall music room and Workshop for artists let creatives meet their needs in style.

The original Union dining hall has been converted to the Refectory Pool, a 48-foot lap pool with the original soaring ceilings, Gothic windows, and chandeliers. To really make a splash, the pool can be converted into a staged floor for private events. Additional amenities include on-site parking, Little Castle children's playroom, and Parkview Lounge and Terrace overlooking Riverside Church, Grant's Tomb, and Sakura Park.

**Schedule an appointment to tour Claremont Hall today.
Call us at (212) 755-5544 | Email us at info@CityRealty.com**

- [Claremont Hall begins sales on Robert A.M. Stern-designed condos in NYC's 'Academic Acropolis'](#)
- [Morningside Heights rises to prominence as new condos offer more value and sensational views](#)
- [Claremont Hall penthouse sets Morningside Heights record](#)
- [Upper West Side New Development Roundup](#)